

GENERAL LAND OFFICE
PRIMER
OF
INSTRUCTIVE INFORMATION
RELATIVE TO
LEGAL SUBDIVISIONS AND PLATS
OF
PUBLIC LAND SURVEYS

Prepared under direction of
I.P. Berthrong
Chief of Drafting Div.

T.O.W.

Publication Printed circa 1921

Reproduced by the U.S. Department of the Interior, Bureau of Land Management,
Eastern States

METHOD OF NUMBERING TOWNSHIPS.

North and South from Base Line and East and West from Meridian.

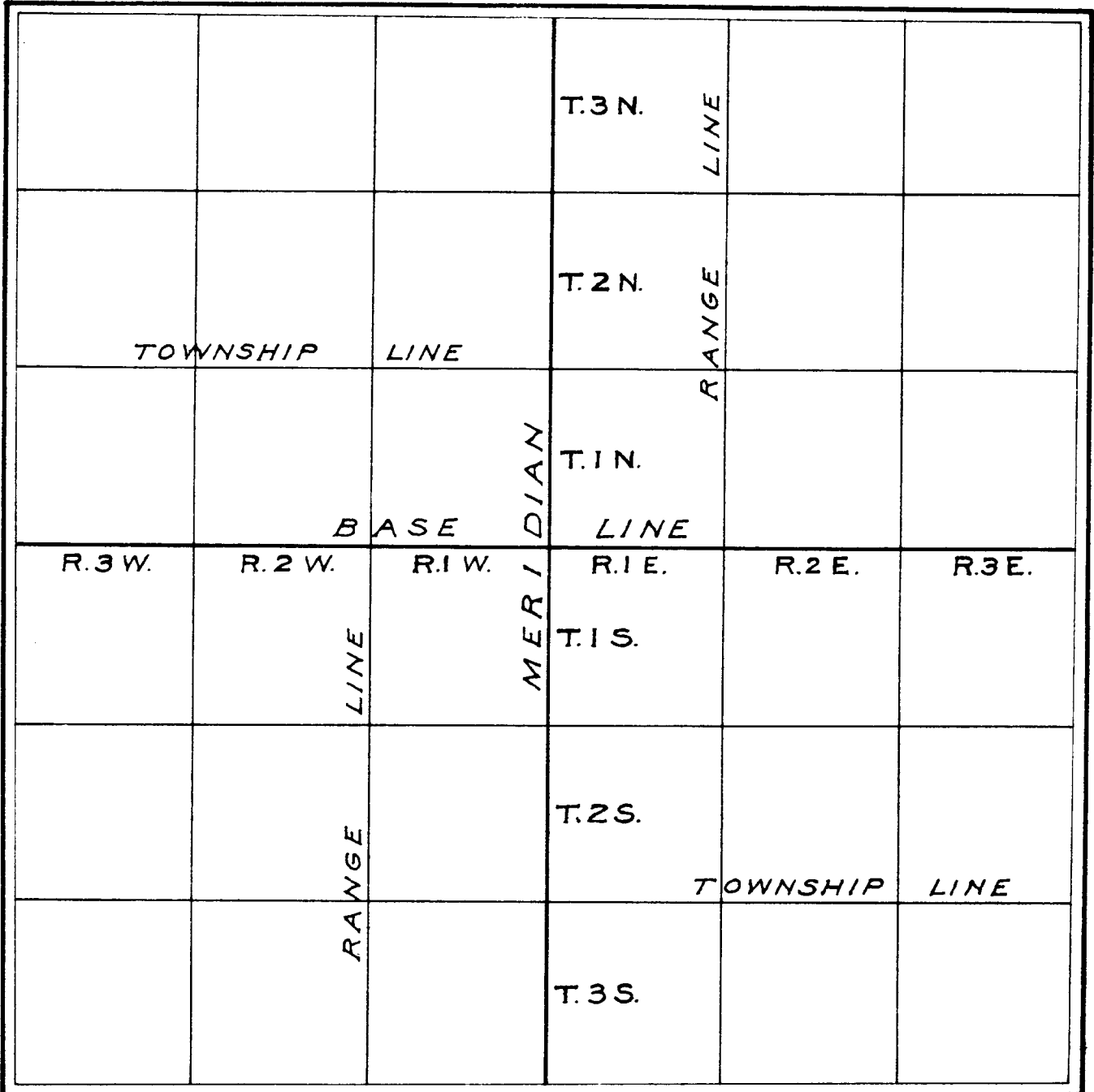

*THEORETICAL
TOWNSHIP DIAGRAM
SHOWING
METHOD OF NUMBERING SECTIONS
WITH ADJOINING SECTIONS*

36 <i>80 Ch.</i>	31	32	33	34	35	36	31 <i>80 Ch.</i>	
<i>6 Miles - 480 Chains</i>								
	<i>1 Mile</i>						<i>80 Ch.</i>	
	6	5	4	3	2	1	6	
	7	8	9	10	11	12	7	
	18	17	16	15	14	13	18	
	19	20	21	22	23	24	19	
	30	29	28	27	26	25	30	
	31	32	33	34	35	36	31	
	6	5	4	3	2	1	6	

LEGAL SUBDIVISIONS OF SECTION

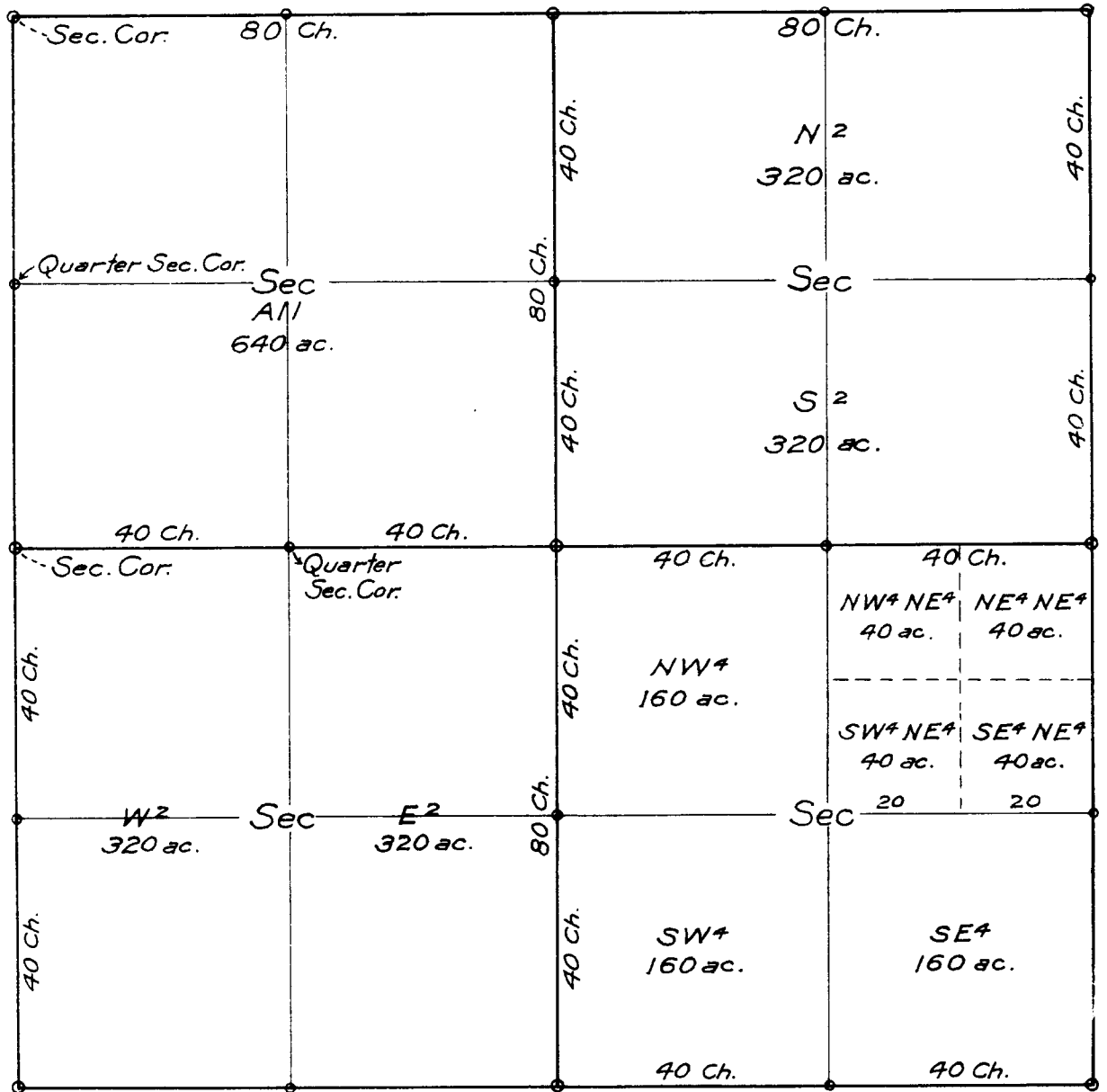

SECTION DIAGRAM SHOWING SMALL SUBDIVISIONS

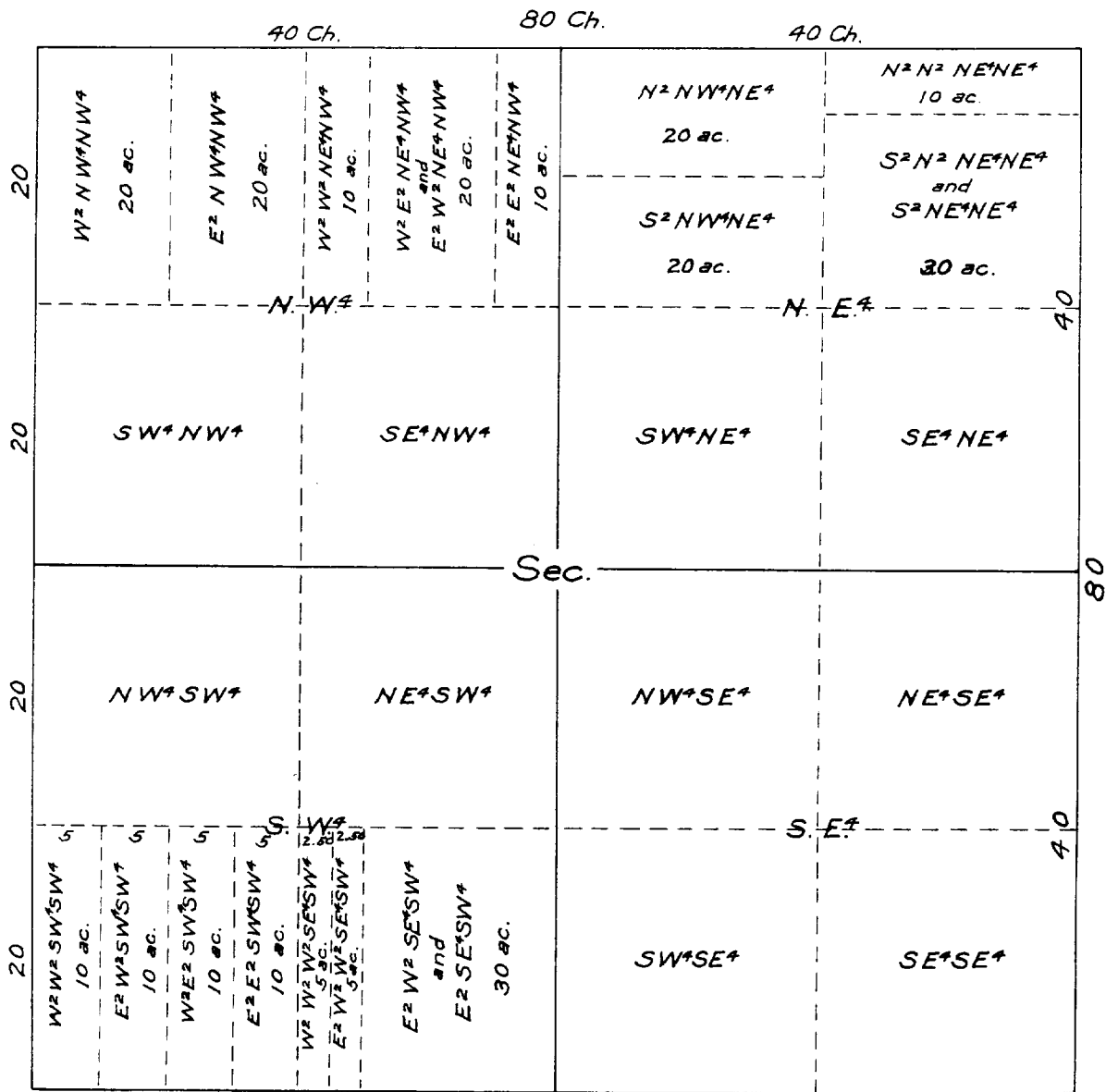

PART OF TOWNSHIP
SHOWING
LEGAL SUBDIVISIONS AND LOTTINGS

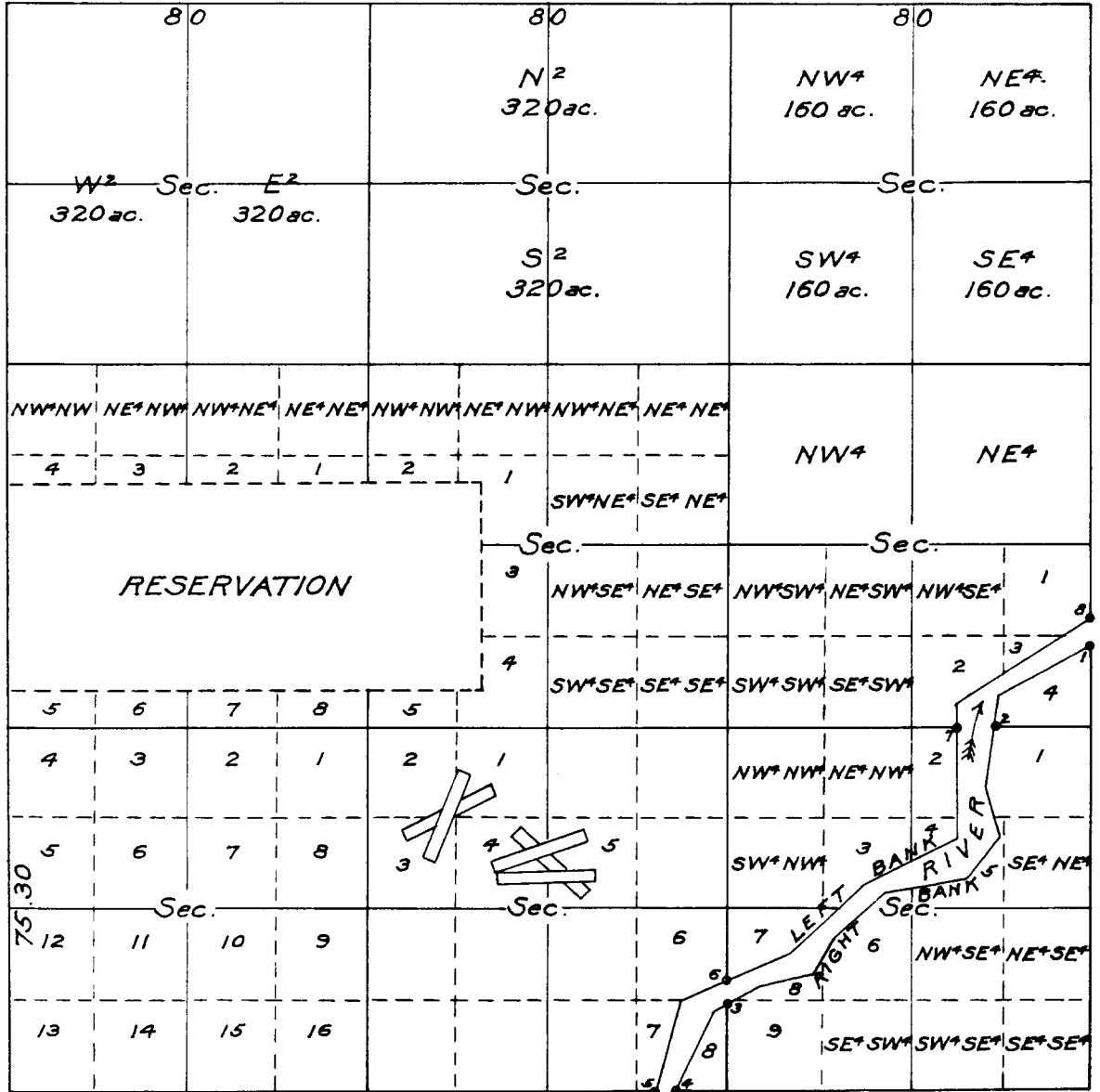

UNITS OF MEASURE

UNITS OF LINEAR MEASURE

1 Mile	equals	5280	feet
1 "	"	80	chains
1 Chain	"	100	links
1 "	"	66	feet
1 Link	"	7.92	inches
1 Rod, Pole or Perch	equals	16½	feet

UNITS OF AREA

1 Acre	equals	10 sq. chains
1 "	"	43560 " feet
1 Sq. Mile	equals	640 acres

A theoretical Township is six miles square, containing thirty six sections, one mile square, of 640 acres each.

Area of a theoretical township
23040 acres.

DIAGRAM
SHOWING
USE OF PROTRACTOR

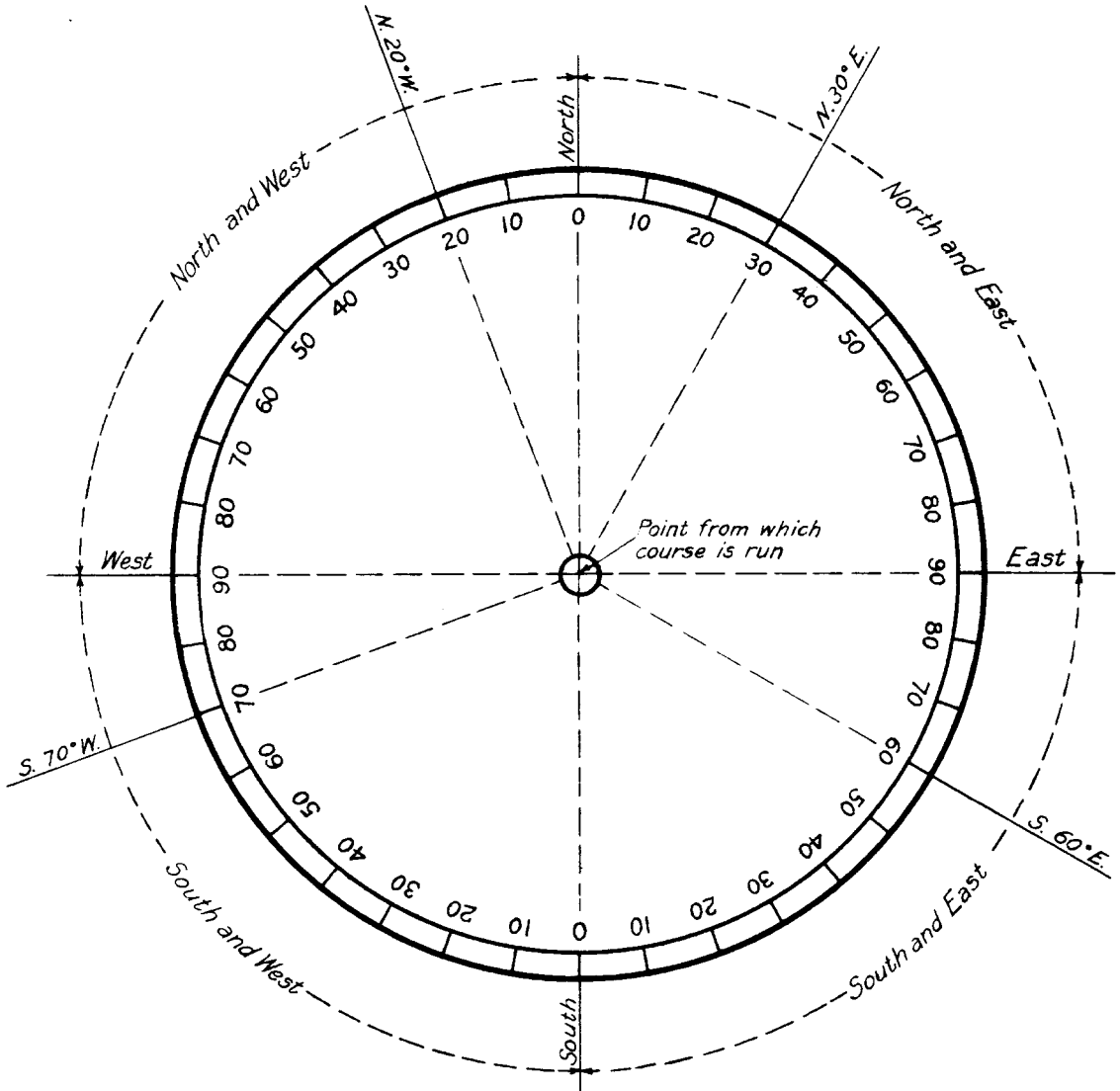

FOR CAREFUL CONSIDERATION AND OBSERVANCE.

The following must be observed in examining the records in the Drafting Division.

First, examine the card index for township plats and diagrams, so that you may be sure that the plat necessary for your case is in the files; it is possible that the plat desired has been withdrawn.

In withdrawing a plat or plat book, leave a receipt card for same, giving the township and range number or the number of volume, the number of your room, the date withdrawn, and sign your name.

Plats must not be retained for a longer period than is absolutely necessary for their use.

In returning plats to the files, it is absolutely necessary that the same be returned to their proper place—loose plats are filed in order, first by range number and then by township number.

Use the greatest care in handling of records—do not fold the plats; in many cases it would be impossible to restore or replace a plat if damaged, destroyed, or lost.

Do not make any notations on face of plat.

William Spry

Commissioner.